

Typical Detail for Urban Tree Soil Tree Pit
Scale 1:50 @ A1

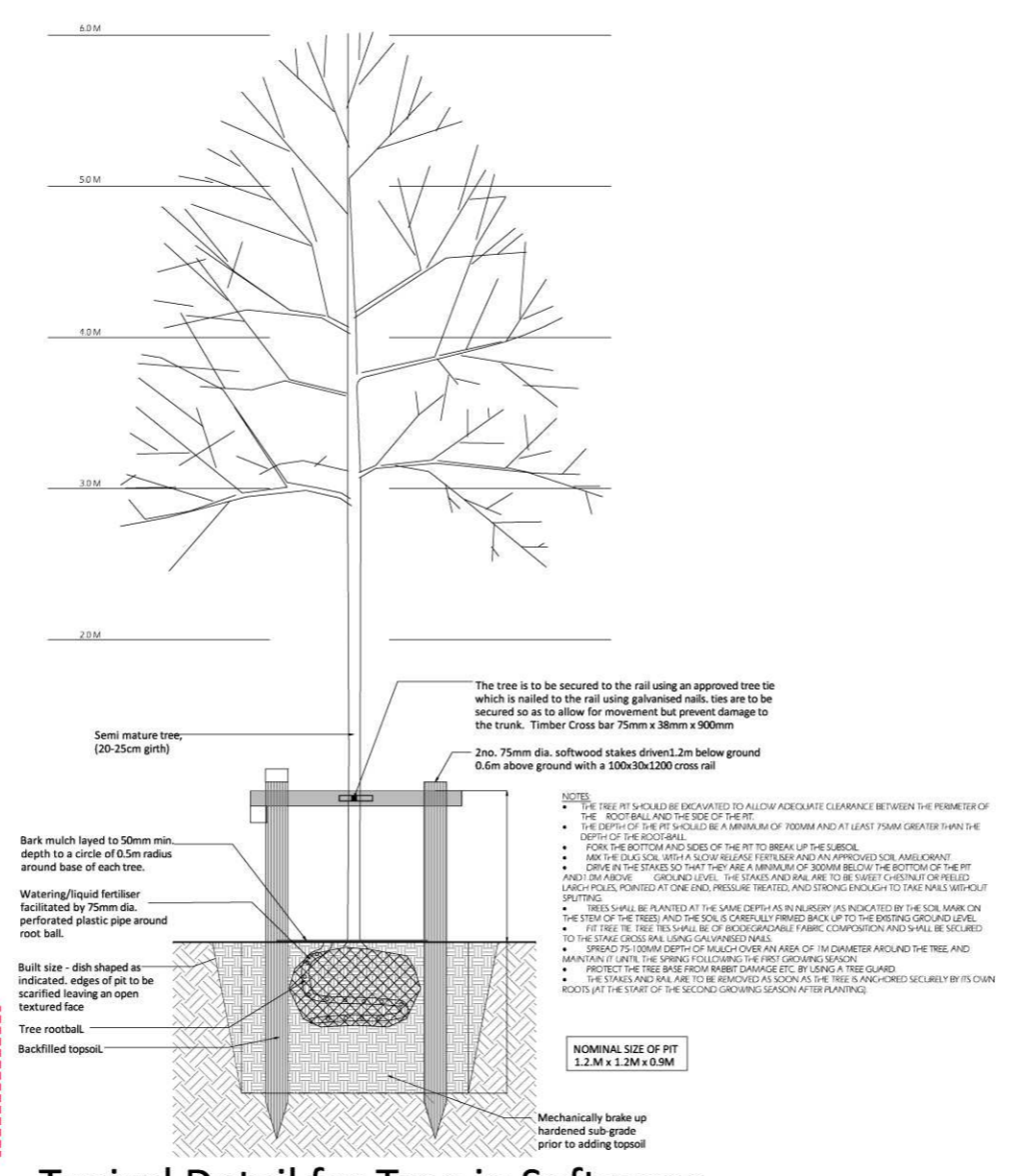

Typical Detail for Tree in Softscape
Scale 1:50 @ A1

Manufactured to the British Soil Standard B.S. 3882:2015

Range of Use	The soil medium will allow Trees in an urban setting to grow in paved areas and high traffic areas with little or no disruption to the surface.
Material	Topsoil, peat-free compost, sand.
Purity	Sustainable free from physical and chemical contaminants and pathogens.
California Bearing Ratio	<40
Soil Portion Texture	Sandy Loam
Moisture Content	12 – 30%
Conductivity	<3300 µS/cm
Plant Available Nutrient Values	Enrich Avg.
Total Nitrogen	>0.290 %w/w
Available Phosphorous	25 – 125 mg/L
Available Potassium	300 – 1,000 mg/L
Available Magnesium	120 – 500 mg/L
Available Calcium	>1,200 mg/L
Available Copper EDTA	7 mg/L
Available Zinc EDTA	10 mg/L
Available Sodium	88 mg/L
Available Sulphate	630 mg/L
Hot Water Soluble Boron	1.3 mg/L
Organic Matter (LOI)	3 – 8 %w/w
pH Value	6 – 8.5
Carbon : Nitrogen Ratio	7-18 : 1
Bulk Density	1,000 – 1,500 g/L

Structural Urban Tree Soil Specification

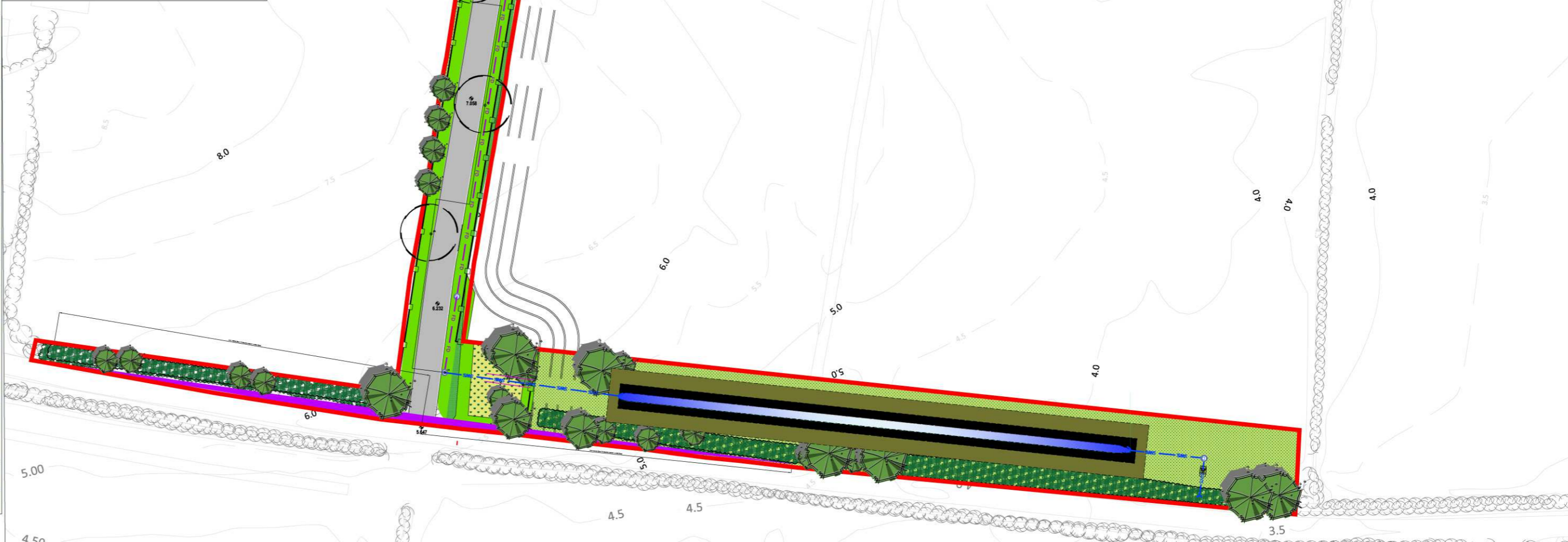
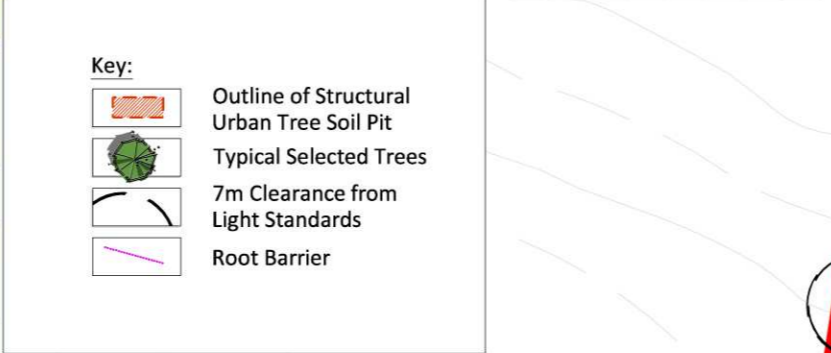

Rev	Date	Drawn	Checked	Description

Notes:

Copyright © All Rights Reserved.
 THIS DRAWING IS THE PROPERTY OF BSM AND SHOULD NOT BE REPRODUCED OR COPIED IN ANY FORM WITHOUT THE WRITTEN PERMISSION OF BSM.
 THIS DRAWING IS TO BE READ IN CONJUNCTION WITH RELEVANT CONSULTANT'S DRAWINGS.

Ordnance Survey Ireland Licence No AR 0001321
 © Ordnance Survey Ireland/Government of Ireland

Project: Portmarnock South Phase 1D
 Drawing No: 311 Rev: 00
 Date: November 2021
 Status: Planning
 Scales: 1:1000 @ A1
 Project No: 6842
 Drawing No: 311 Rev: 00
 Date: November 2021
 Status: Planning
 Scales: 1:1000 @ A1
 Project No: 6842
 Drawing No: 311 Rev: 00
 Date: November 2021
 Status: Planning
 Scales: 1:1000 @ A1

Project: Portmarnock South Phase 1D
 Drawing No: 311 Rev: 00
 Date: November 2021
 Status: Planning
 Scales: 1:1000 @ A1
 Project No: 6842
 Drawing No: 311 Rev: 00
 Date: November 2021
 Status: Planning
 Scales: 1:1000 @ A1

BSM
 Est. 1968